

# Fingangsfoyer

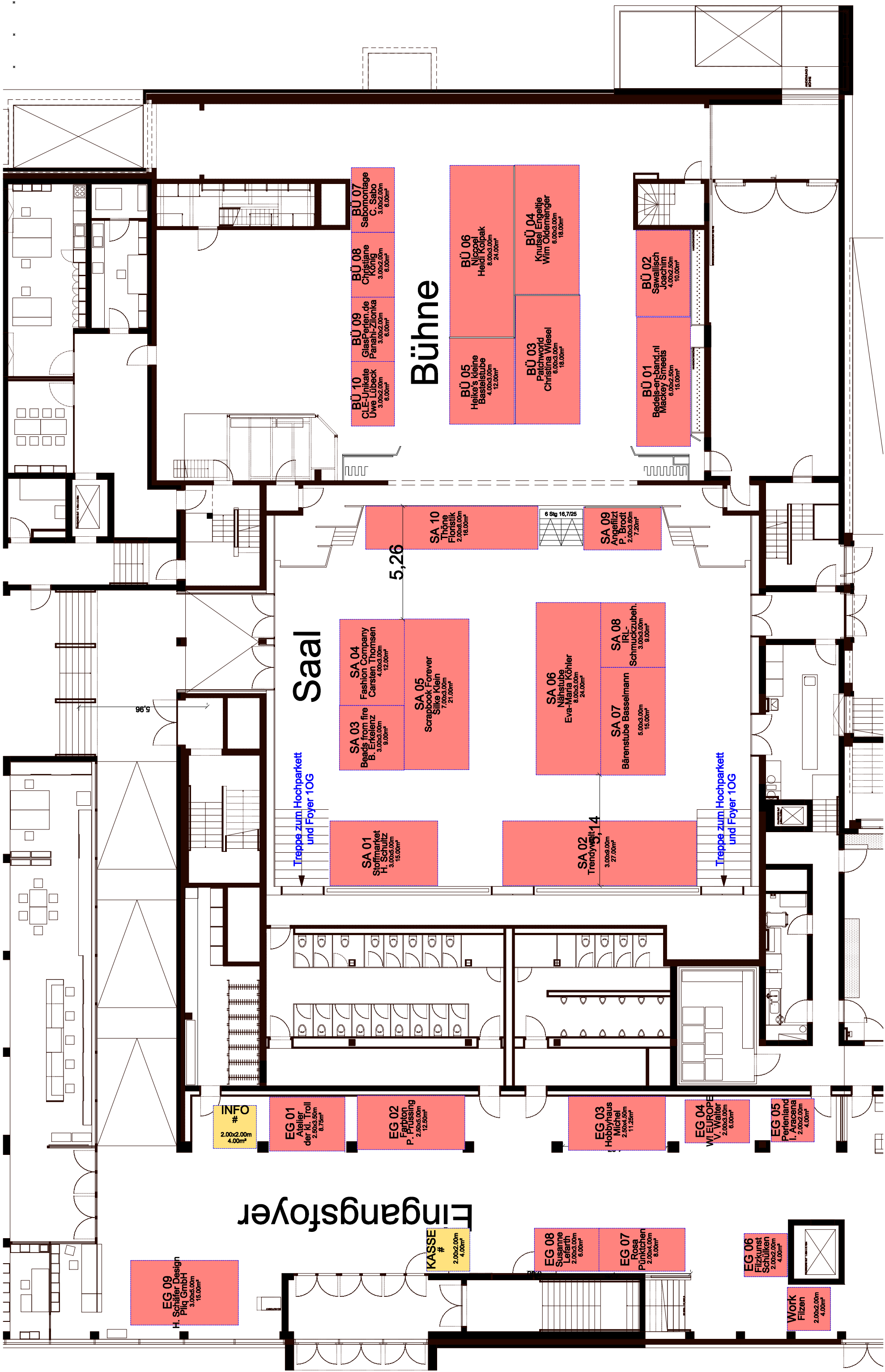

**EG 09**  
H. Schiefer Design  
3.00x3.00m  
9.00m<sup>2</sup>

**KASSE #**  
2.00x2.00m  
4.00m<sup>2</sup>

**EG 08**  
Susanne Lefarth  
2.00x3.00m  
6.00m<sup>2</sup>

**EG 07**  
Rosa Pünktchen  
2.00x4.00m  
8.00m<sup>2</sup>

**EG 06**  
Flizkunst Schülken  
2.00x2.00m  
4.00m<sup>2</sup>

**Work**  
Flizen  
2.00x2.00m  
4.00m<sup>2</sup>

**INFO #**  
2.00x2.00m  
4.00m<sup>2</sup>

**EG 01**  
Atelier der Kl. Troll  
2.50x3.50m  
8.75m<sup>2</sup>

**EG 02**  
Fashion P. Prüssing  
2.50x5.00m  
12.50m<sup>2</sup>

**EG 03**  
Hobbyhaus Michel  
2.50x4.50m  
11.25m<sup>2</sup>

**EG 04**  
W. EUROPE V. Walter  
2.00x3.00m  
6.00m<sup>2</sup>

**EG 05**  
Perfektland I. Aracena  
2.00x3.00m  
6.00m<sup>2</sup>

Treppe zum Hochparkett und Foyer 10G

## Saal

5,26

**SA 01**  
Stoffmarkt H. Schultz  
3.00x5.00m  
15.00m<sup>2</sup>

**SA 03**  
Beads from fire B. Erkelenz  
3.00x3.00m  
9.00m<sup>2</sup>

**SA 04**  
Fashion Company Carsten Thomsen  
4.00x3.00m  
12.00m<sup>2</sup>

**SA 05**  
Scrapbook Forever Silke Klein  
7.00x3.00m  
21.00m<sup>2</sup>

**SA 02**  
Trendywelt 14  
3.00x9.00m  
27.00m<sup>2</sup>

**SA 06**  
Nähstube Eva-Maria Köhler  
8.00x3.00m  
24.00m<sup>2</sup>

**SA 07**  
Bärenstube Besselmann  
5.00x3.00m  
15.00m<sup>2</sup>

**SA 08**  
IRL- Schmirckzubeh.  
3.00x3.00m  
9.00m<sup>2</sup>

**SA 10**  
Throne Floristik  
2.00x6.00m  
12.00m<sup>2</sup>

**SA 09**  
Angelizit P. Brodt  
2.00x3.50m  
7.00m<sup>2</sup>

## Bühne

**BÜ 10**  
CIE-Unitate Uvie Lübeck  
3.00x2.00m  
6.00m<sup>2</sup>

**BÜ 09**  
GlasPerlen.de Parahitz-Zilanka  
3.00x2.00m  
6.00m<sup>2</sup>

**BÜ 08**  
Christiane König  
3.00x2.00m  
6.00m<sup>2</sup>

**BÜ 07**  
Sabomontage C. Sabo  
3.00x2.00m  
6.00m<sup>2</sup>

**BÜ 05**  
Heike's kleine Bastelstube  
4.00x3.00m  
12.00m<sup>2</sup>

**BÜ 03**  
Patchwork Christina Wiesel  
6.00x3.00m  
18.00m<sup>2</sup>

**BÜ 06**  
Nippel Heidi Kolpak  
8.00x3.00m  
24.00m<sup>2</sup>

**BÜ 04**  
Knitsel Engelife Wim Oldemenger  
6.00x3.00m  
18.00m<sup>2</sup>

**BÜ 01**  
Bedele-ers'and.nl Mackey Smeets  
6.00x3.00m  
18.00m<sup>2</sup>

**BÜ 02**  
Sawallisch Joschim  
4.00x2.50m  
10.00m<sup>2</sup>

5,96

Treppe zum Hochparkett und Foyer 10G